

use stock angle or make as bent sheet metal part.  
0.06 thickness is fine.

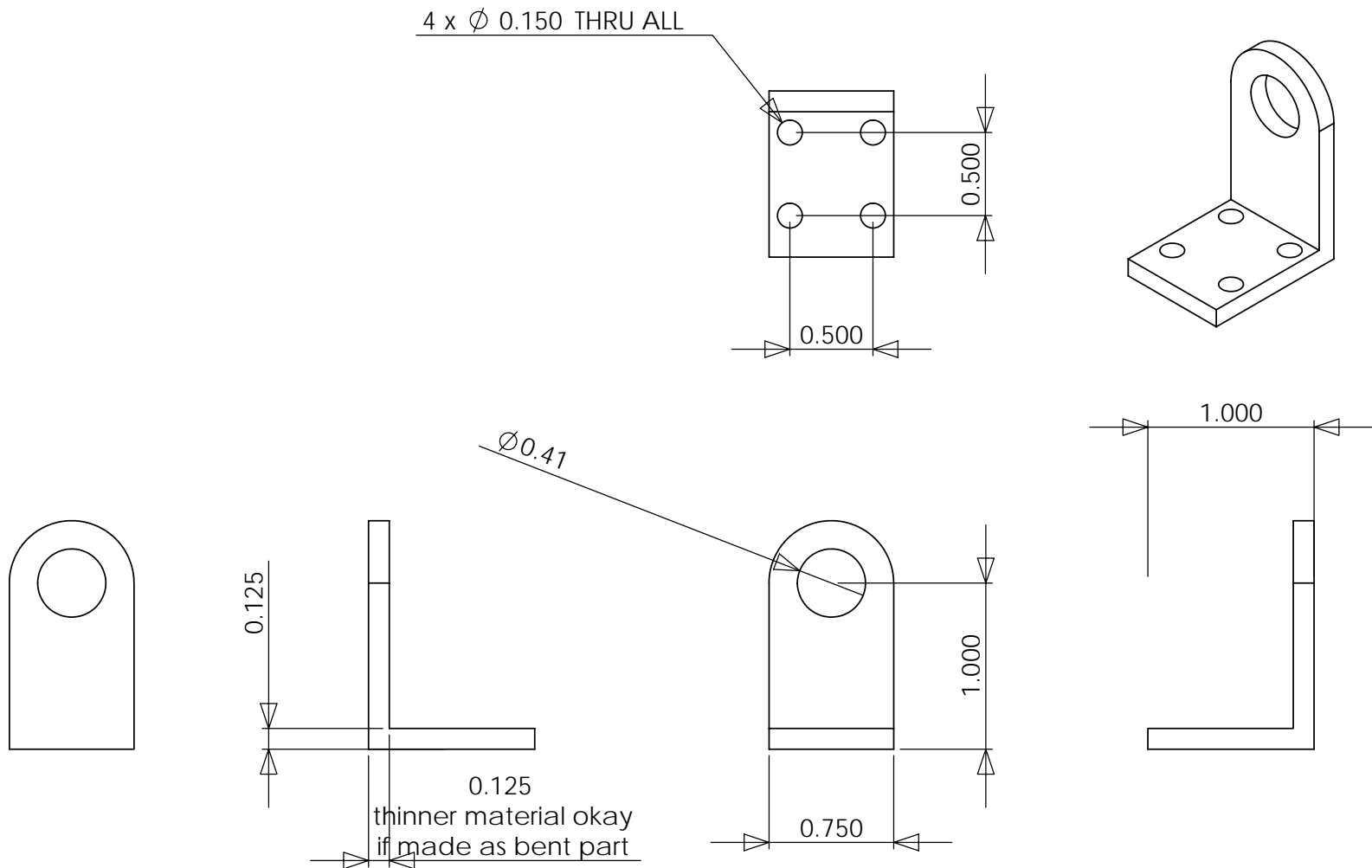

4/1/2008

MIT CSAIL		77 MASSACHUSETTS AVENUE RM 32-380 CAMBRIDGE, MA 02139	
Drawn by: Dan @ 617-504-9619			
n11-neck-pot-holder			
Quantity: 1 piece		Scale: 1:1	
Material:	Finish:		1/1